

MARINA EXECUTIVE TOWER

Empowering Dreams, Achieving Success

“MUHAMMAD ALI SOCIETY”

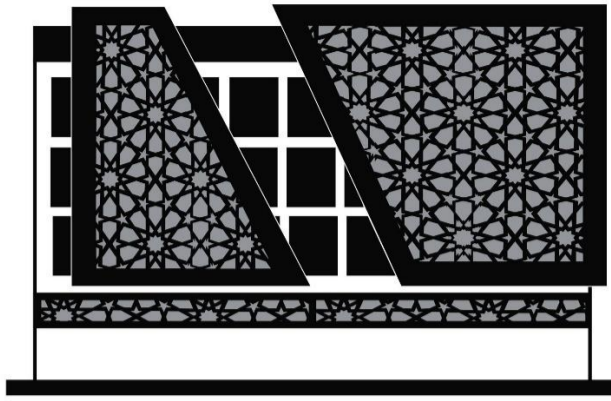



MARINA EXECUTIVE TOWER

Empowering Dreams, Achieving Success



PROJECT FEATURES

OFFICES AND SHOWROOMS

- 2 basements for indoor car parking available for all offices within the building.
- Backup generator and 24-hour CCTV surveillance.
- Modern offices equipped with the latest materials.
- 3 high-speed lifts for convenient access.
- Reception area and reception lobby featuring highly interior design.
- Offices with a gross area of 1500+ sqft are eligible for an additional free washroom if needed.
- Firefighting equipment and more amenities are also included.

AMENITIES (Recreation)

- GYM / FITNESS CENTER
- MASJID
- COMMON SMOKING / VAPING ROOM ON EACH FLOOR

OFFICE FULL FLOOR PLANNING

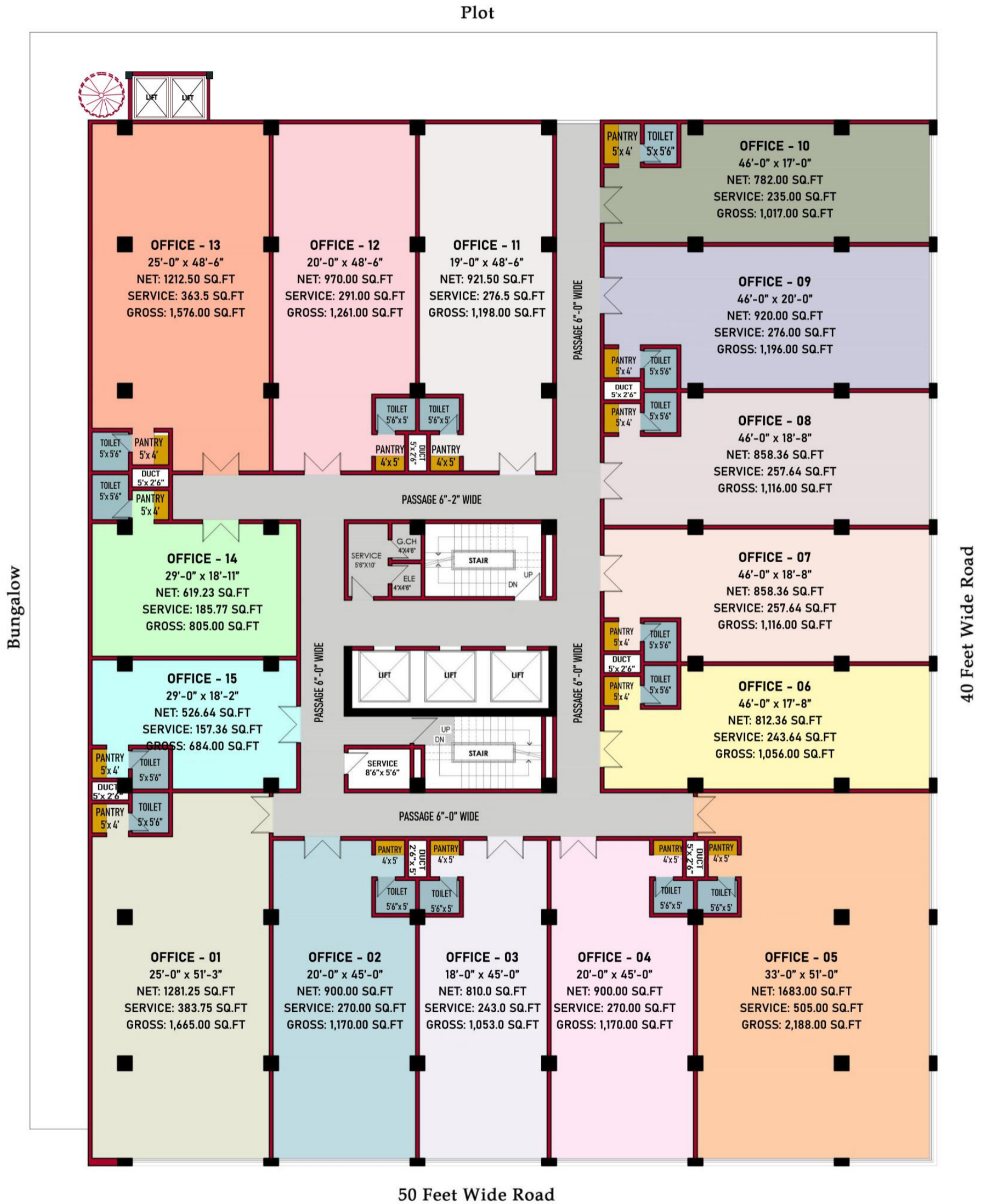

1st to 4th Floor Plan

OFFICES PRICE LIST

OFFICE # 1
1665 Sq.Fts (Gross)
5,32,80,000

OFFICE # 2
1170 Sq.Fts (Gross)
3,74,40,000

OFFICE # 3
1053 Sq.Fts (Gross)
3,36,96,000

OFFICE # 4
1170 Sq.Fts (Gross)
3,74,40,000

OFFICE # 5
2188 Sq.Fts (Gross)
7,00,16,000

OFFICE # 6
1056 Sq.Fts (Gross)
3,37,92,000

OFFICE # 7
1116 Sq.Fts (Gross)
3,57,12,000

OFFICE # 8
1116 Sq.Fts (Gross)
3,57,12,000

OFFICE # 9
1196 Sq.Fts (Gross)
3,82,72,000

OFFICE # 10
1017 Sq.Fts (Gross)
3,25,44,000

OFFICE # 11
1198 Sq.Fts (Gross)
3,83,36,000

OFFICE # 12
1261 Sq.Fts (Gross)
4,03,52,000

OFFICE # 13
1576 Sq.Fts (Gross)
5,04,32,000

OFFICE # 14
805 Sq.Fts (Gross)
2,57,60,000

OFFICE # 15
684 Sq.Fts (Gross)
2,18,88,000

Note: Total Estimated File Price is excluded from Stamp Duty, Advance Tax, E7 Tax, Any Tax (Required for Sub-Lease), Capital Value Tax, Capital Gain Tax, Registrar Fees, Lawyer Fees, Documentation Fees, Misc, Property Tax, Excise & Taxation, and All Utility Connections 1. Electric (Approval/Connection/Meter/P.M.T/Sub-Station/Grid Station/High & Low Tension Cables/Misc/All Material/Billing) Charges, 2. Gas (Connection/Meter/Main Line/Approval/Misc/All Material/Billing) Charges. 3. Water & Sewerage (Connection/Approval/Meter/Misc/All Material/R.O. Plant/Billing) are extra amount whatsoever decided by Company on later stages to be paid by the File Holder upon demand.

24 MONTH (2 Years) PAYMENT SCHEDULE FOR OFFICES & SHOWROOMS

<u>Payment Schedule</u>	<u>OFFICES</u>
On Booking (Within 120 Days)	25%
24 monthly installments after down payment	2% per month
One month before Work Complete	BALANCE

SERVENT QUARTER CHARGES: - (4.5ft X 7ft) (Optional if required)

SERVENT QUARTER Charges = 10,00,000

EXTRA PARALLEL PARKING: - (Optional if required)

Extra Parking Charges = 20,00,000

Note: Total Estimated File Price is excluded from Stamp Duty, Advance Tax, E7 Tax, Any Tax (Required for Sub-Lease), Capital Value Tax, Capital Gain Tax, Registrar Fees, Lawyer Fees, Documentation Fees, Misc, Property Tax, Excise & Taxation, and All Utility Connections 1. Electric (Approval/Connection/Meter/P.M.T/Sub-Station/Grid Station/High & Low Tension Cables/Misc/All Material/Billing) Charges, 2. Gas (Connection/Meter/Main Line/Approval/Misc/All Material/Billing) Charges. 3. Water & Sewerage (Connection/Approval/Meter/Misc/All Material/R.O. Plant/Billing) are extra amount whatsoever decided by Company on later stages to be paid by the File Holder upon demand.



SHOWROOMS ON GROUND FLOOR

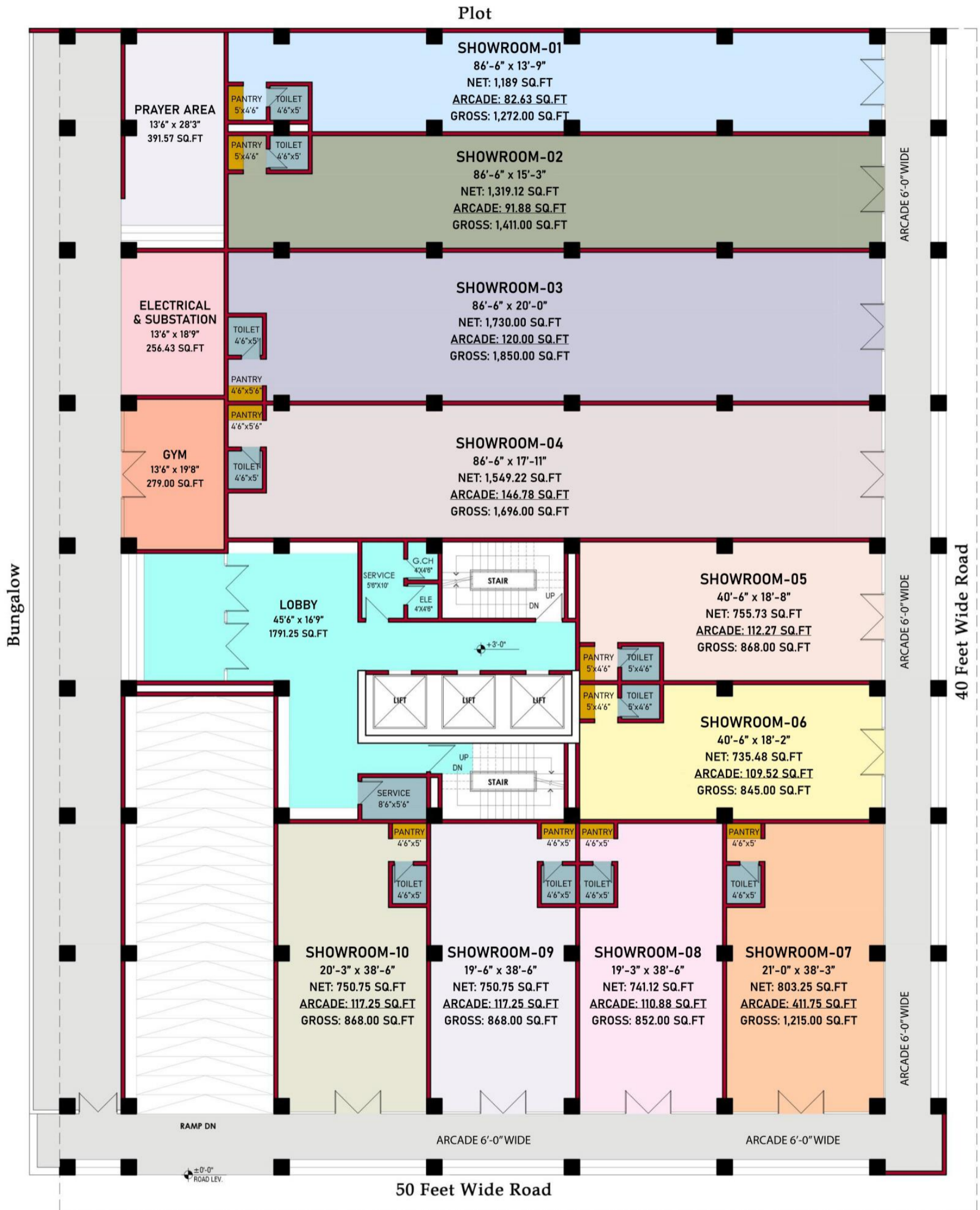

GROUND FLOOR PLAN

SHOWROOMS ON GROUND FLOOR

PRICE LIST

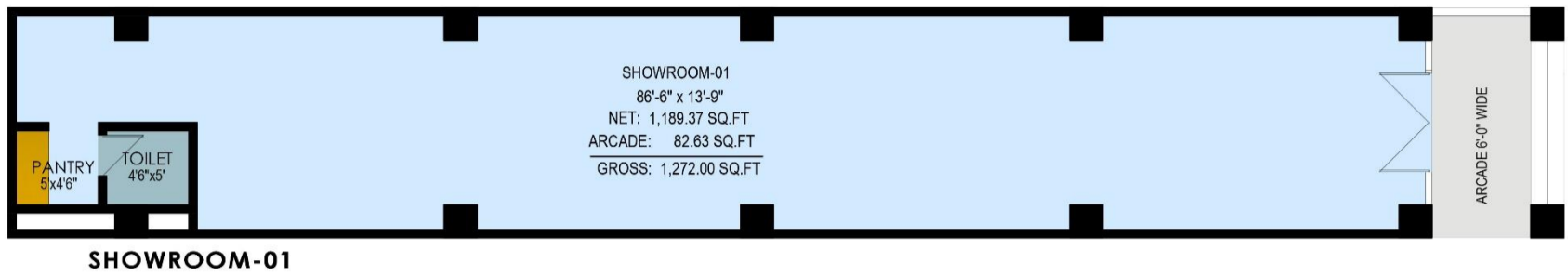

SHOWROOM # 1

1272 Sq.Fts (Gross)

4,95,88,000

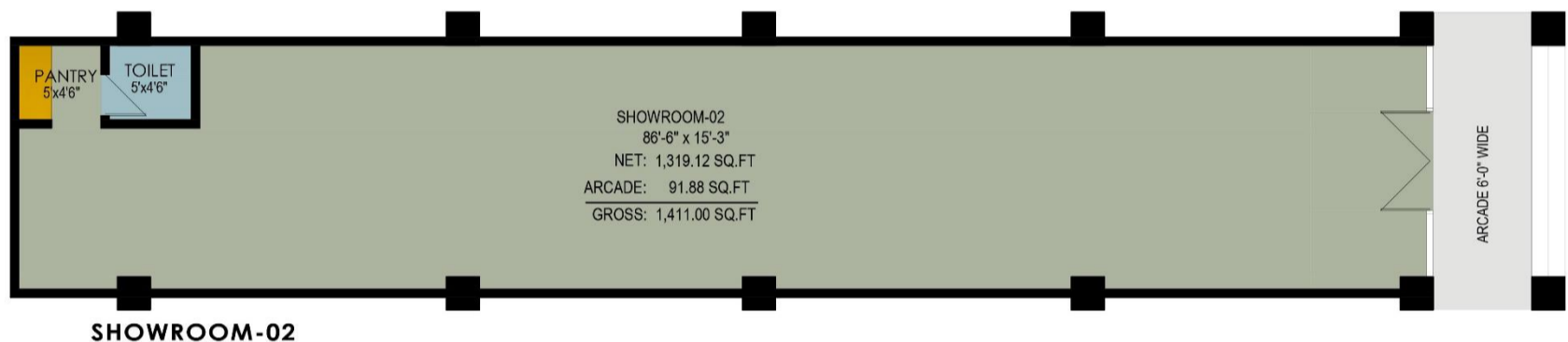

SHOWROOM # 2

1411 Sq.Fts (Gross)

5,86,44,000

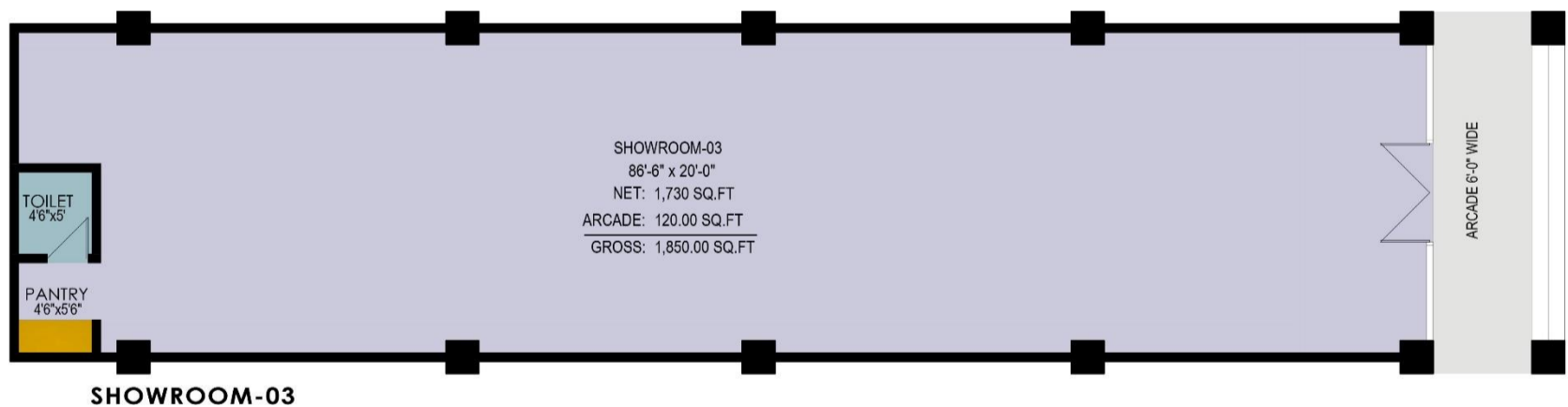

SHOWROOM # 3

1850 Sq.Fts (Gross)

8,14,00,000

Note: Total Estimated File Price is excluded from Stamp Duty, Advance Tax, E7 Tax, Any Tax (Required for Sub-Lease), Capital Value Tax, Capital Gain Tax, Registrar Fees, Lawyer Fees, Documentation Fees, Misc, Property Tax, Excise & Taxation, and All Utility Connections 1. Electric (Approval/Connection/Meter/P.M.T/Sub-Station/Grid Station/High & Low Tension Cables/Misc/All Material/Billing) Charges, 2. Gas (Connection/Meter/Main Line/Approval/Misc/All Material/Billing) Charges. 3. Water & Sewerage (Connection/Approval/Meter/Misc/All Material/R.O. Plant/Billing) are extra amount whatsoever decided by Company on later stages to be paid by the File Holder upon demand.

SHOWROOMS ON GROUND FLOOR

PRICE LIST



SHOWROOM # 4

1696 Sq.Fts (Gross)

8,32,84,000

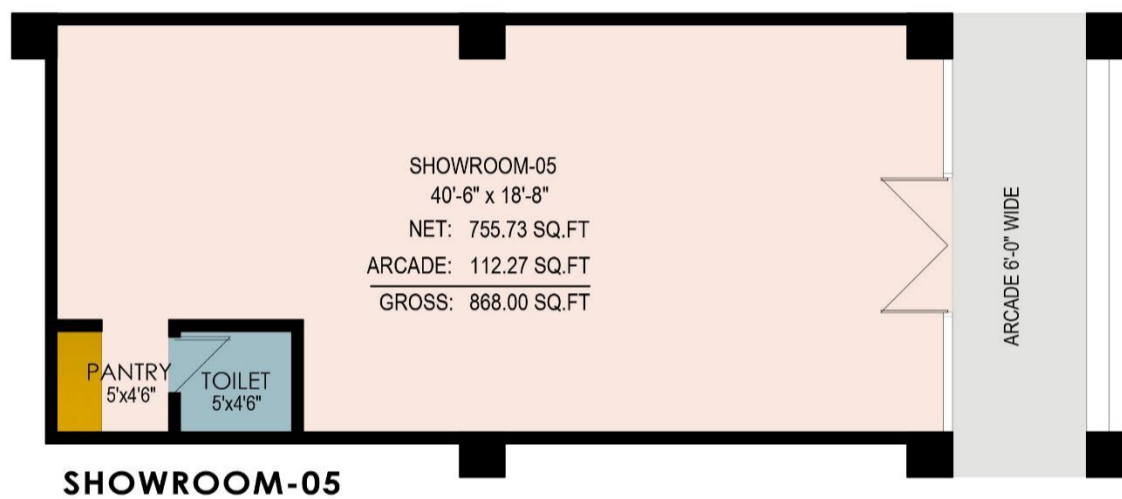

SHOWROOM # 5

868 Sq.Fts (Gross)

4,70,00,000

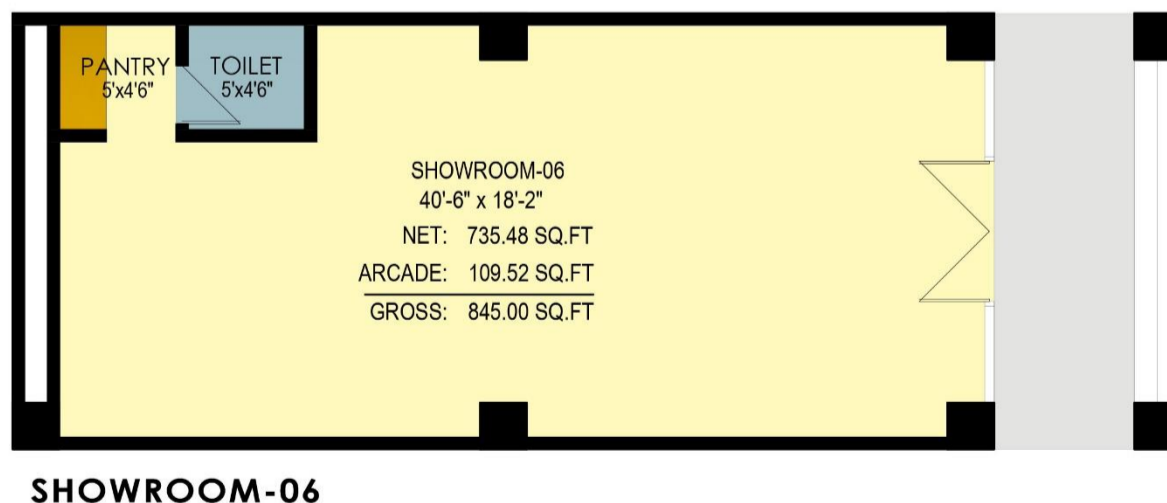

SHOWROOM # 6

845 Sq.Fts (Gross)

4,98,80,000

Note: Total Estimated File Price is excluded from Stamp Duty, Advance Tax, E7 Tax, Any Tax (Required for Sub-Lease), Capital Value Tax, Capital Gain Tax, Registrar Fees, Lawyer Fees, Documentation Fees, Misc, Property Tax, Excise & Taxation, and All Utility Connections 1. Electric (Approval / Connection / Meter / P.M.T / Sub-Station / Grid Station / High & Low Tension Cables / Misc / All Material / Billing) Charges, 2. Gas (Connection / Meter / Main Line / Approval / Misc / All Material / Billing) Charges, 3. Water & Sewerage (Connection / Approval / Meter / Misc / All Material / R.O. Plant / Billing) are extra amount whatsoever decided by Company on later stages to be paid by the File Holder upon demand.

SHOWROOMS ON GROUND FLOOR

PRICE LIST

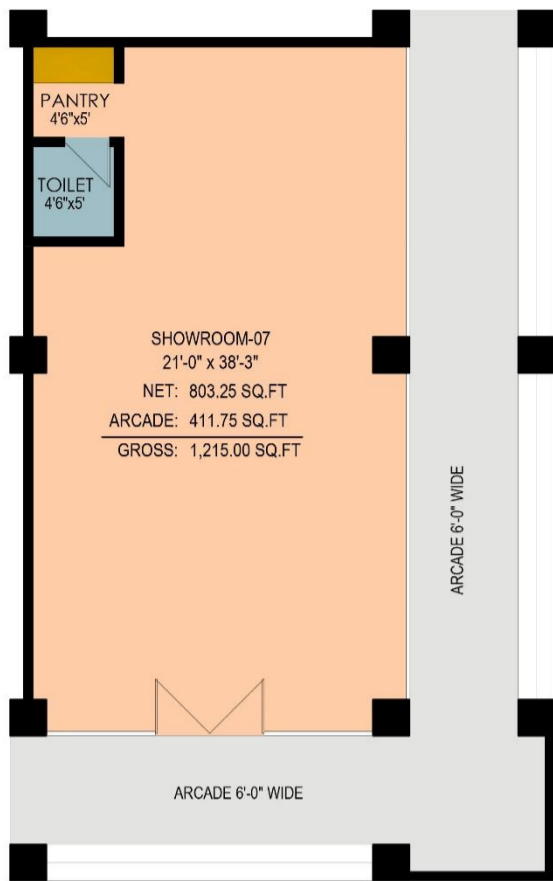

SHOWROOM-07

SHOWROOM # 7
1215 Sq.Fts (Gross)
7,79,00,000

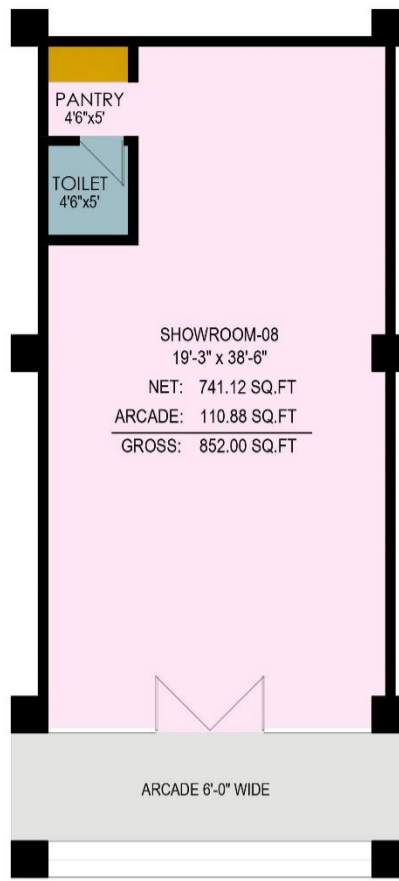

SHOWROOM-08

SHOWROOM # 8
852 Sq.Fts (Gross)
5,24,00,000

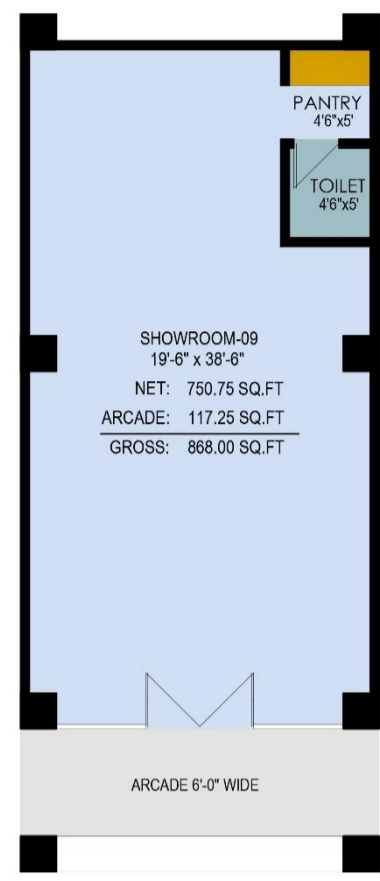

SHOWROOM-09

SHOWROOM # 9
868 Sq.Fts (Gross)
5,15,00,000

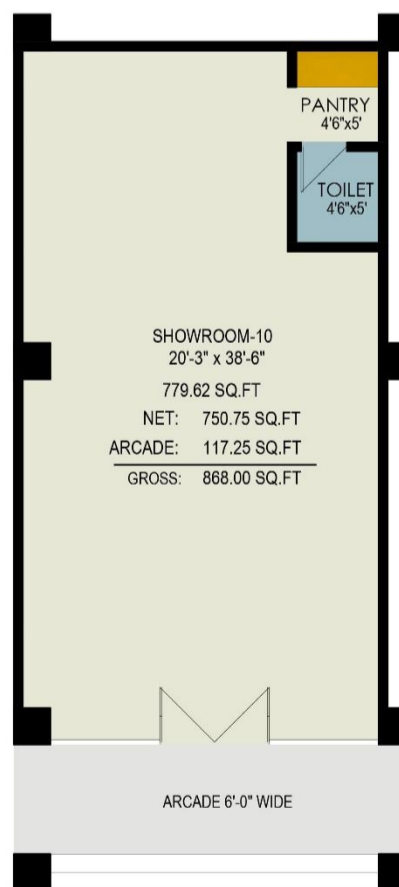

SHOWROOM-10

SHOWROOM # 10
868 Sq.Fts (Gross)
4,90,00,000

Note: Total Estimated File Price is excluded from Stamp Duty, Advance Tax, E7 Tax, Any Tax (Required for Sub-Lease), Capital Value Tax, Capital Gain Tax, Registrar Fees, Lawyer Fees, Documentation Fees, Misc, Property Tax, Excise & Taxation, and All Utility Connections 1. Electric (Approval/Connection/Meter/P.M.T/Sub-Station/Grid Station/High & Low Tension Cables/Misc/All Material/Billing) Charges, 2. Gas (Connection/Meter/Main Line/Approval/Misc/All Material/Billing) Charges. 3. Water & Sewerage (Connection/Approval/Meter/Misc/All Material/R.O. Plant/Billing) are extra amount whatsoever decided by Company on later stages to be paid by the File Holder upon demand.



DOWNLOAD THE LATEST PDF FROM BY SCANNING THE BELOW Q R CODE FROM YOUR MOBILE



LAST UPDATED ON: Saturday, May 4, 2024

Disclaimer: All Picture, Plans, Layouts, Information, Data and Details included in this brochure are indicative only and may change at any time up to the final "as built" status in accordance with the final designs of the project and regulatory approvals and planning permission.